

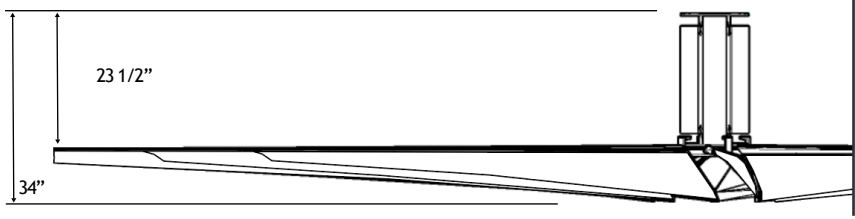

TECHNICAL SPECIFICATIONS

STANDARD MOUNT - NO EXTENSION



MOUNTING EXTENSION

3' and 6' Kits Standard, Modifications to Order

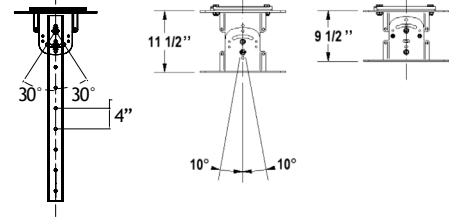

Technical Specifications				
Fan Diameter	8 ft.	12 ft.	16 ft.	20 ft.
Number of Airfoils	8 Airfoils			
Color Options	 Brushed Aluminum / White / Black / Red / Yellow / Blue / Gold / Green			
Fan Weight	91 lbs.	109 lbs.	127 lbs.	161 lbs.
Motor Enclosure	Totally Enclosed Fan-Cooled			
Motor Power	0.5 HP			1.0 HP
Maximum RPM	44 RPM	44 RPM	44 RPM	39 RPM
Maximum CFM*	~45,000 CFM	~90,100 CFM	~123,000 CFM	~197,000 CFM
Sound Level (dBA)**	<57 dBA	<57 dBA	<57 dBA	59 dBA
Direct Breeze Region ***	28 - 32 ft. diameter	42 - 48 ft. diameter	56 - 64 ft. diameter	70 - 80 ft. diameter
Best Industrial Spacing ****	42 ft.	63 ft.	84 ft.	105 ft.
Max Square Footage ****	4,250 sq. ft.	8,500 sq. ft.	12,750 sq. ft.	19,750 sq. ft.
Input Power	110-120V, 1φ: 13.0 A 208-240V, 1φ: 6.4 A 208-240V, 3φ: 3.7 A 460-480V, 3φ: 1.85 A			208-240V, 1φ: 12.3 A 208-240V, 3φ: 7.12 A 460-480V, 3φ: 3.50 A
Motor Maximum Full Load Amps	208-240V: 1.90 A 460-480V: 0.95 A			208-240V: 3.66 A 460-480V: 1.83 A
Minimum Airfoil Clearances	Sides: 2 ft. Ceiling Deck: 4 ft.	Sides: 2 ft. Ceiling Deck: 5 ft.	Sides: 2ft. Ceiling Deck: 6 ft.	Sides: 2 ft. Ceiling Deck 6 ft.
Standard Mount	I-Beam/Z-Purlins/Open Joist			
Extensions	3 ft. and 6 ft. Mounting Extensions Available			
Controller	NEMA 1 Wall Mounted VFD w/Safety Disconnect, On/Off Toggle and Speed Pot			
Safety Features	Safety Cable, Hub Clips, Hub Retainer, Dual-Method Fastening of all Joined Components, Integrated Sprinkler Shut-Off			
Warranty	5 Years All Parts			

* CFM measurements are an approximation derived from several factors. AMCA does not certify CFM ratings for fans larger than 8' in diameter.
 ** dBA measurements taken directly beneath units running at 3/4 speed in an active work environment.
 *** For applications in which breeze production/ventilation is the foremost consideration, applies to operation at 1/2 max speed with a clear floor.
 **** For applications in which heating/cooling cost reduction is the foremost consideration